

ODU AMC[®] HIGH-DENSITY COAXIAL CONNECTOR RECEPTACLE STYLE 6 ASSEMBLY INSTRUCTION

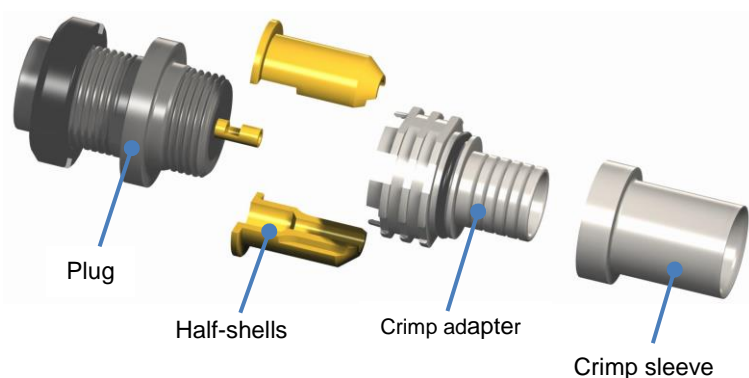

A PERFECT ALLIANCE.

1 Assembly sequence



Size	max. cable Ø mm
00 (C)	5.0



1. Slide crimp sleeve and crimp adapter over the cable.



Fastening tape
ODU advise Crepe masking tape
e.g. Würth: 09920019

2. Strip the cable and conductors. Fold back the shield and use fastening tape to fasten it to the cable jacket. Tin-plate this wires if needed.



3. Solder the inner conductor to the contact. Clean the solder area with Isopropylalcohol and brush.



4. Assemble the half-shells.

ODU AMC[®] HIGH-DENSITY COAXIAL CONNECTOR RECEPTACLE STYLE 6 ASSEMBLY INSTRUCTION

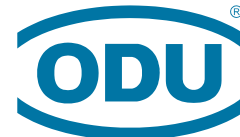

A PERFECT ALLIANCE.

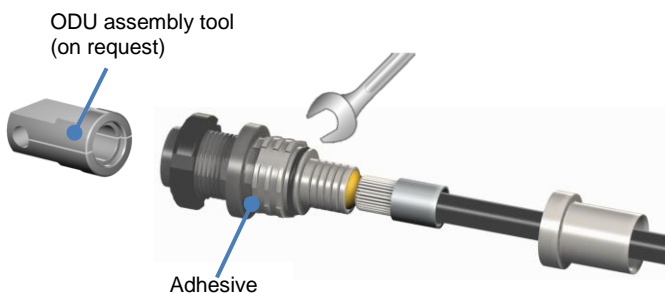

5. Screw the crimp adapter on so that it is flush, observing torque values (see page 4). Secure the screw thread with adhesive. If necessary use the assembly tool (see 3.2).



6. Remove the fastening tape and lay the shield braid on to the crimp adapter. Fasten the shield braid to the crimp adapter by means of crimping.



7. Strain relief: Encapsulate the end of the crimp sleeve to prevent stress on the cable connection. Bend relief: If necessary, this can be implemented by means of overmolding or by using a shrink tube.

ODU AMC[®] HIGH-DENSITY COAXIAL CONNECTOR RECEPTACLE STYLE 6 ASSEMBLY INSTRUCTION

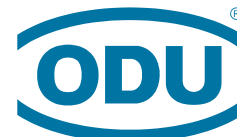

A PERFECT ALLIANCE.

2 Cable Preparation

The following table provides recommended guidelines for cable preparation. The according stripping measures have to be checked before assembly!

recommended cable preparation

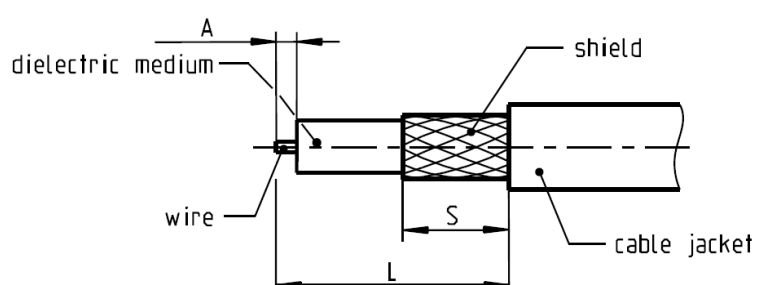

A = Stripping length single conductor
L = Stripping length cable jacket
S = Stripping length braided shield

Size	Contact Ø	L	A	S
00	0.7	9	3	9

All dimensions in mm
Tolerance: +10 %

Exceptions are noted on special instructions.

ODU AMC[®] HIGH-DENSITY COAXIAL CONNECTOR RECEPTACLE STYLE 6 ASSEMBLY INSTRUCTION

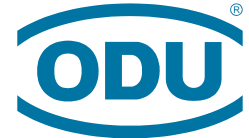

A PERFECT ALLIANCE.

3 Assembly Crimp Adapter

Size	Torque Nm	Reference Dimension X mm
00 (C)	0.5	12.3

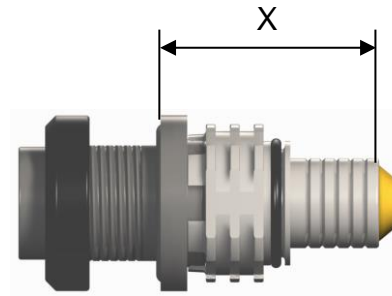

3.1 Spann wrench

Size	Part number	Wrench size
00 (C)	598.700.001.001.000	8

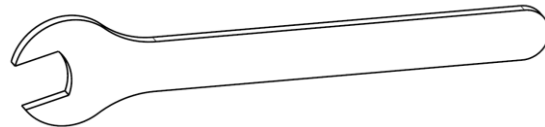

3.2 Assembly tool

Size	Part number
00 (C)	713.650.902.631.000

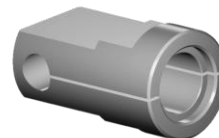

3.3 Adhesive

Secure the crimp adapter on housing with adhesive. (ODU reference: Loctite 2701)

3.4 Potting the interior of the crimp adapter

Encapsulate the interior of the crimp adapter to secure the soldered points with 2K casting resin PU. (ODU reference Araldite 2014-02)

ODU AMC[®] HIGH-DENSITY COAXIAL CONNECTOR RECEPTACLE STYLE 6 ASSEMBLY INSTRUCTION

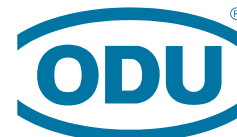

A PERFECT ALLIANCE.

4 Assembly crimp sleeve

4.1 Crimp tool ODU

Hand-crimptong	
Size	Part number
all	080.000.026.000.000

Crimp dies	
Size	Part number
00 (C)	080.000.026.713.002

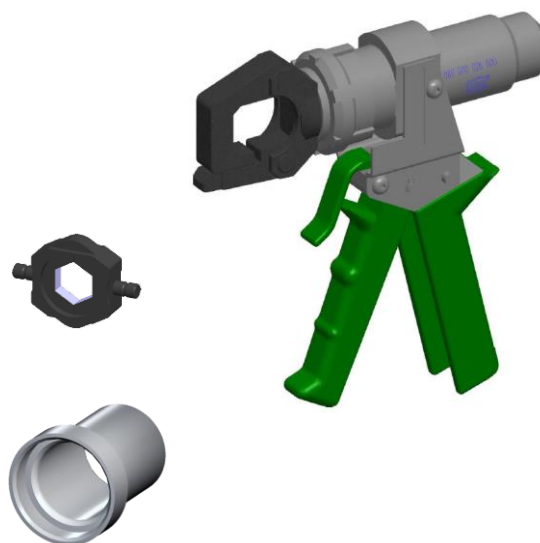

5 Cable interface

ODU provides three different solutions for the cable interface. According to the requirements the customer can chose between overmolding, heat shrinkable molded parts and heat shrinkable tubing.

5.1 ODU overmolding (recommended series solution)

ODU provides complete solutions with straight overmoldings on request.



Example image: Break-Away Plug and In-Line Receptacle (size 00)

ODU AMC[®] HIGH-DENSITY COAXIAL CONNECTOR RECEPTACLE STYLE 6 ASSEMBLY INSTRUCTION

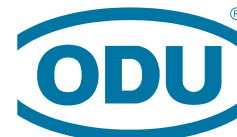

A PERFECT ALLIANCE.

5.2 Heat shrinkable molded parts (samples, pre-series)

Size	Part number		Min. cable Ø in mm
	ODU	Supplier	
00 (C)	921.000.010.008.103	202K111-25 (Tyco)	3.0

To a better adhesion of the heatshrink boots on housing and cable, ODU recommends to work with an epoxyd-adhesion (e. g. Hellermann V9500, Raychem S1125).



Example image: Break-Away Plug and In-Line Receptacle (size 1)

5.3 Heat shrinkable tubing (samples, pre-series)

Size	Part Number		Min. cable Ø in mm
	ODU	Tyco	
00 (C)	921.000.010.008.093	ATUM-12/3	3.0

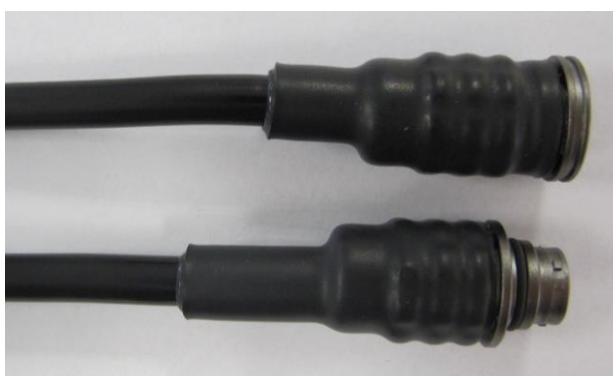

Example image: Break-Away Plug and In-Line Receptacle (size 1)