

A PERFECT ALLIANCE.



# ODU-MAC<sup>®</sup> RAPID HOUSING

**Blue-Line**

**White-Line**

Assembly instruction



Safety instructions / protective conductor connection

A protective conductor termination is mandatorily required if the „limits for **TOUCHABLE PARTS**“ described in the respective standards are exceeded and no other protective measures against electric shock have been taken. In any case, before commissioning, a check of the protective connection and all **TOUCHABLE PARTS** must be carried out according to the relevant standards.

When mated, the housing listed in this data sheet corresponds to the requirements specified in DIN EN 61984:2009 with regard to protection against contact in accordance with DIN EN 60529:1998.

The back of the device must be secured against touching. The customer must ensure strain relief for the cables / strands on the device part.

ASSEMBLY INSTRUCTION

ODU-MAC® RAPID HOUSING .....	03 – 06
OPTIONAL: PROTECTIVE COVER .....	07
ODU-MAC® RAPID RECEPTACLE	
A. Recessed assembly of the socket frame in assembly wall .....	08 – 09
B. Direct assembly of the socket frame on assembly wall .....	10 – 11



A. Recessed assembly of the socket frame in assembly wall

B. Direct assembly of the socket frame on assembly wall

### ATTENTION!

For all assembly steps ODU-MAC® Blue-Line size 4 is shown.  
They also apply to ODU-MAC® Blue-Line size 2 and ODU-MAC® White-Line.

# ODU-MAC® RAPID HOUSING

## Step 1

- Cut the grommet with a **cutter** according to the cable diameter.

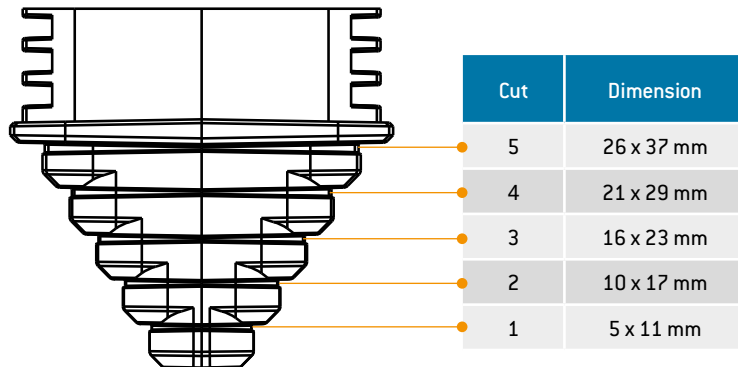

## Step 2

- Slide the grommet over the wires.

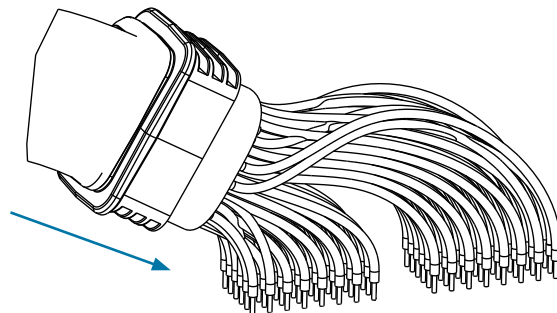

## Step 3

- Assemble the cables with the contacts according to the configuration and put the contacts into the modules and then into the frame.

- For ODU-MAC® Blue-Line:  
see [assembly instruction ODU-MAC® Blue-Line](#)
- For ODU-MAC® White-Line:  
see [assembly instruction ODU-MAC® White-Line](#)

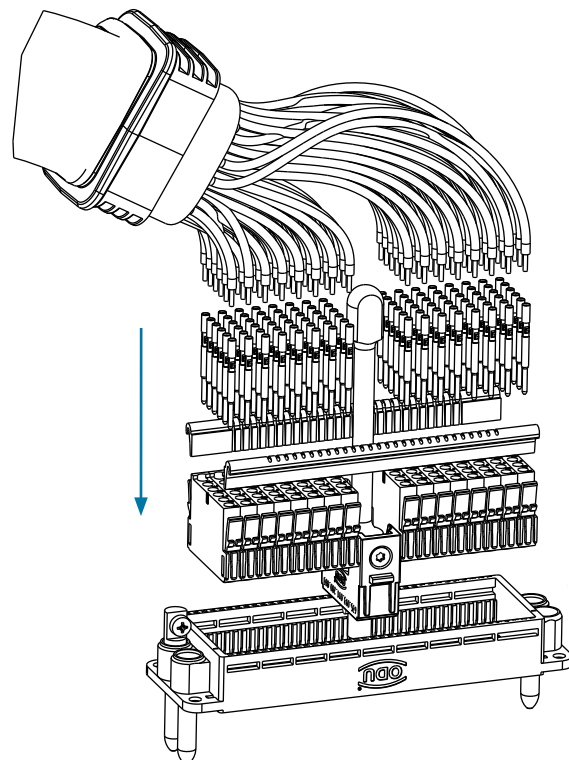

## Step 4 (optional)

- Optionally assemble the strain relief plate(s) – size 2 (1 plate) and size 4 (2 plates) – into the housing.  
Drive: **TX10**, locking torque: **0.9 Nm ±0.2 Nm**

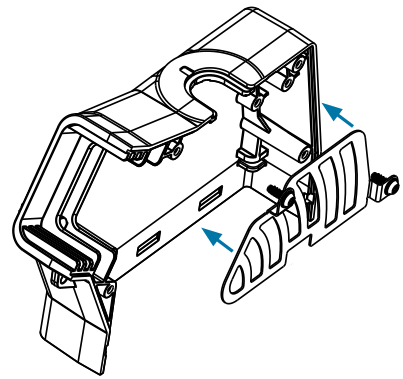

## Step 5

- Put the knob on the spindle bolt.

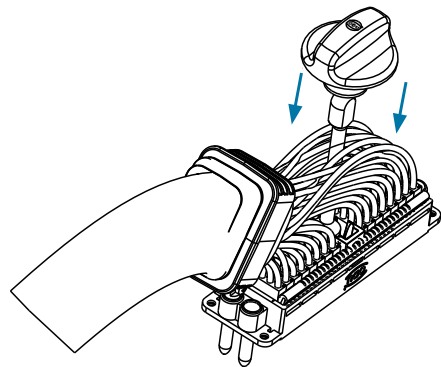

## Step 6

- Put the assembly into the housing.

### ATTENTION!

The **PE-connection** is on the same side as the cable exit.

Slide the grommet into the housing.

Optionally use cable ties to fix the cables onto the strain relief plate.

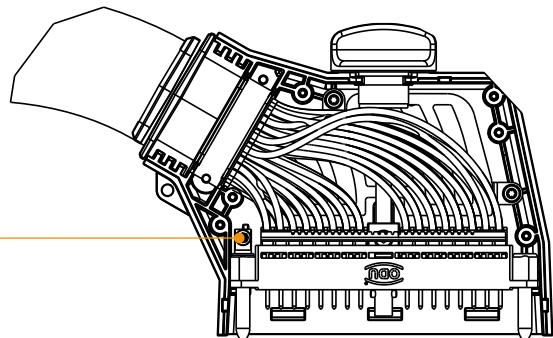

## Step 7 (optional for size 4)

- Assemble **second strain relief plate** and fix the cables with cable ties.

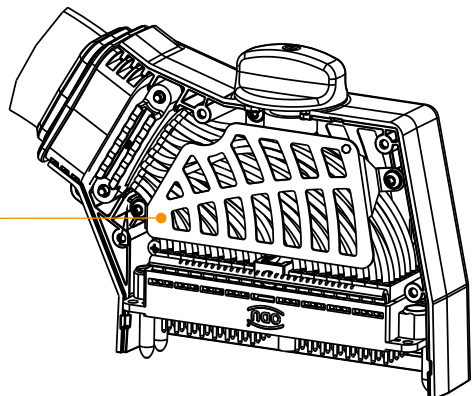

## Step 8

- Assembly of **strain relief**: screw from the back of the housing.  
Drive: **TX10**, locking torque: **0.9 Nm  $\pm$  0.2 Nm**

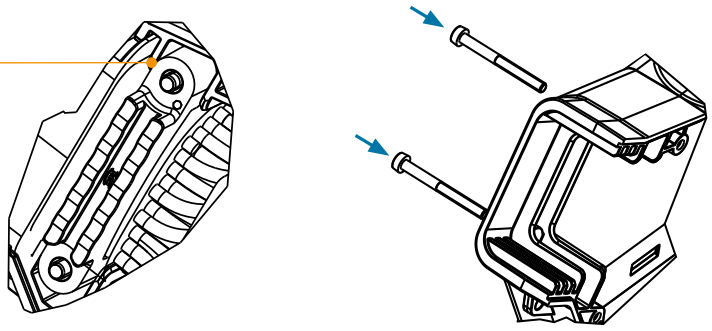

## Step 9

- Put the upper housing shell on the housing and tighten with the enclosed screws (4x).  
Drive: **TX10**, locking torque: **0.9 Nm  $\pm$  0.2 Nm**

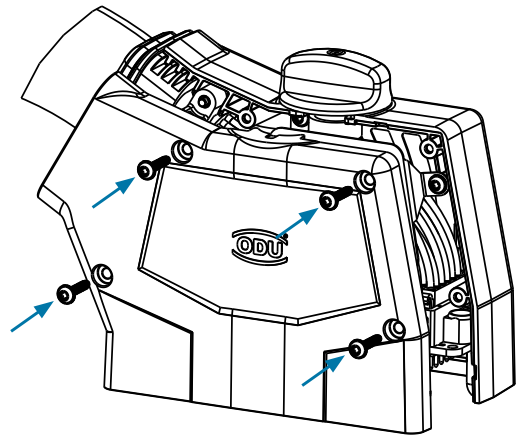

## OPTIONAL: PROTECTIVE COVER / HOUSING

### Step 1

- Pull the lanyard through the hole on the housing.

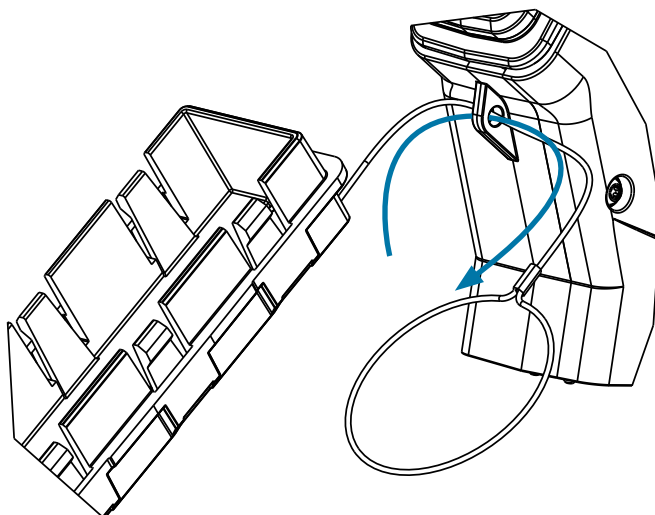

### Step 2

- Put the protective cover through the loop and tighten the lanyard.

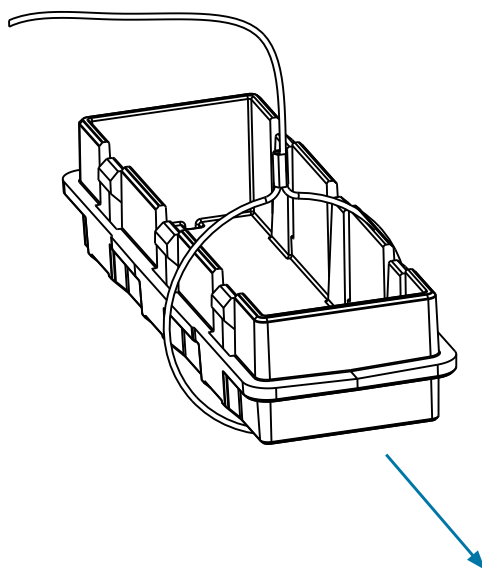

# ODU-MAC® RAPID RECEPTACLE

A. Recessed assembly of the socket frame in assembly wall

## Step 1

- Put the cable through the panel cut out and the ODU-MAC® RAPID receptacle.

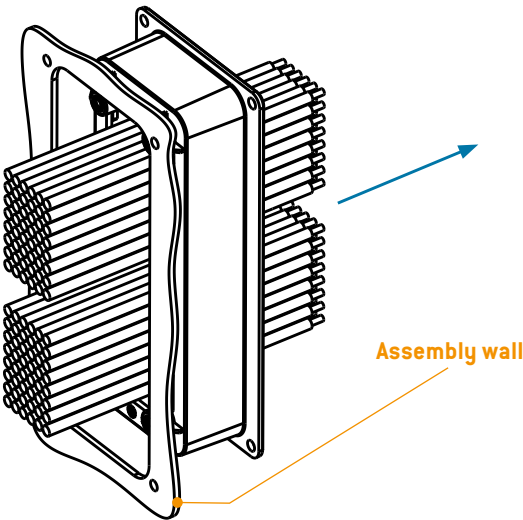

## Panel cut out

### ATTENTION!

- Assembly wall must be designed stable enough to ensure tightness!

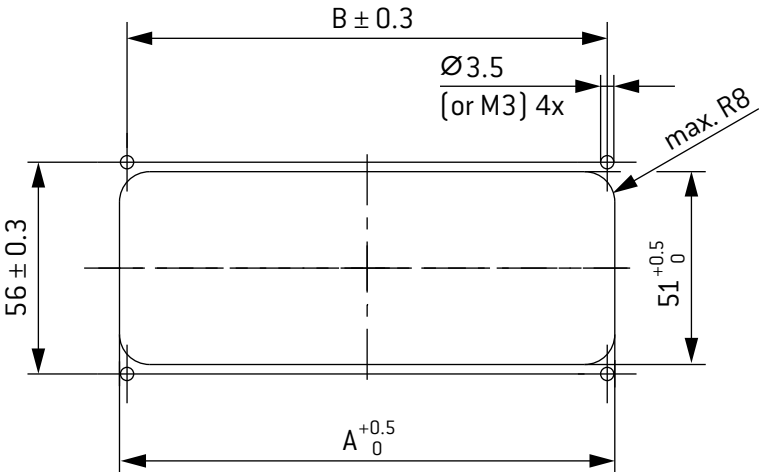

Part number	Part-ID	Size	Color	A	B
656.561.001.003.000	50287633	2	white	84	80
656.561.001.008.000	50282951		black		
656.563.001.003.000	50257931	4	white	131	127
656.563.001.008.000	50257848		black		



## Step 2

- ▶ Assemble the cables with the contacts according to the configuration and put the contacts into the modules and then into the frame.

- For ODU-MAC® Blue-Line:  
see [assembly instruction ODU-MAC® Blue-Line](#)
- For ODU-MAC® White-Line:  
see [assembly instruction ODU-MAC® White-Line](#)

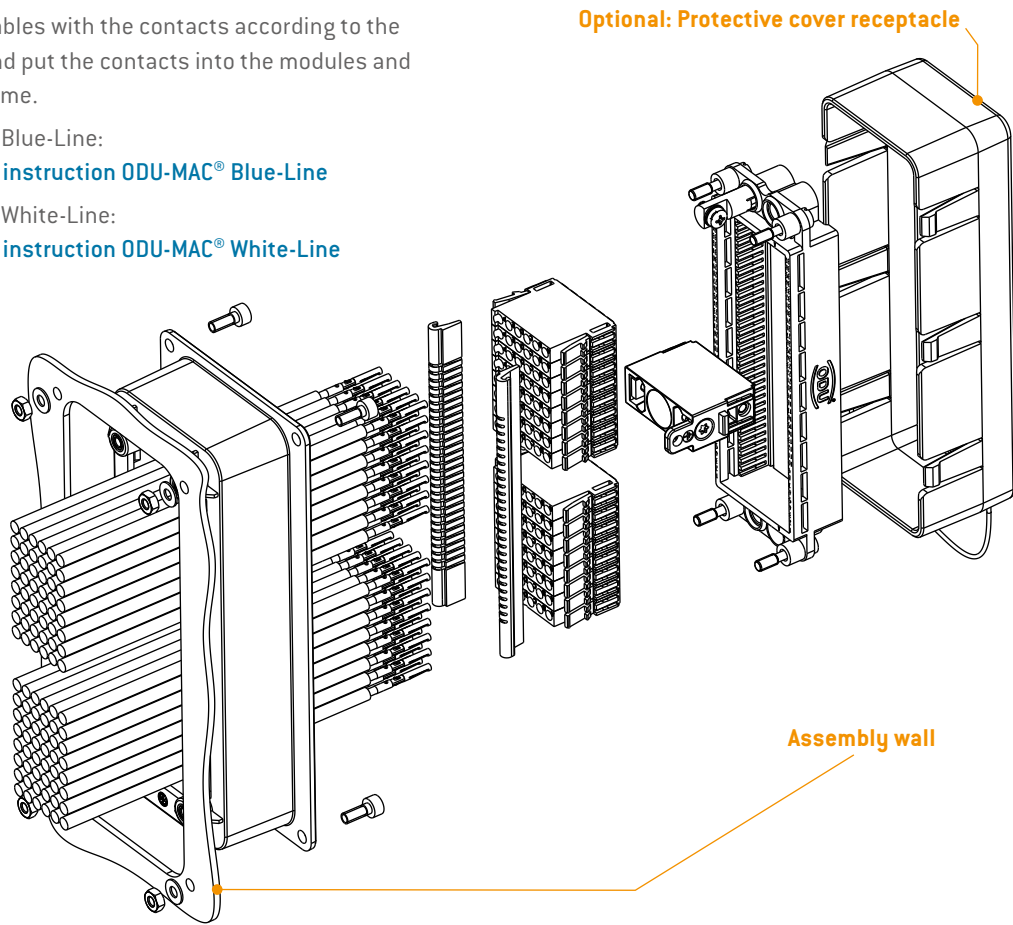

## Step 3

- ▶ Mount the assembled ODU-MAC® RAPID socket frame into the receptacle. Afterwards mount the set on your assembly wall (screws not included). Protective cover can be fixed onto the fixing point of the receptacle.

Max. locking torque: **1.2 Nm ±0.2 Nm**

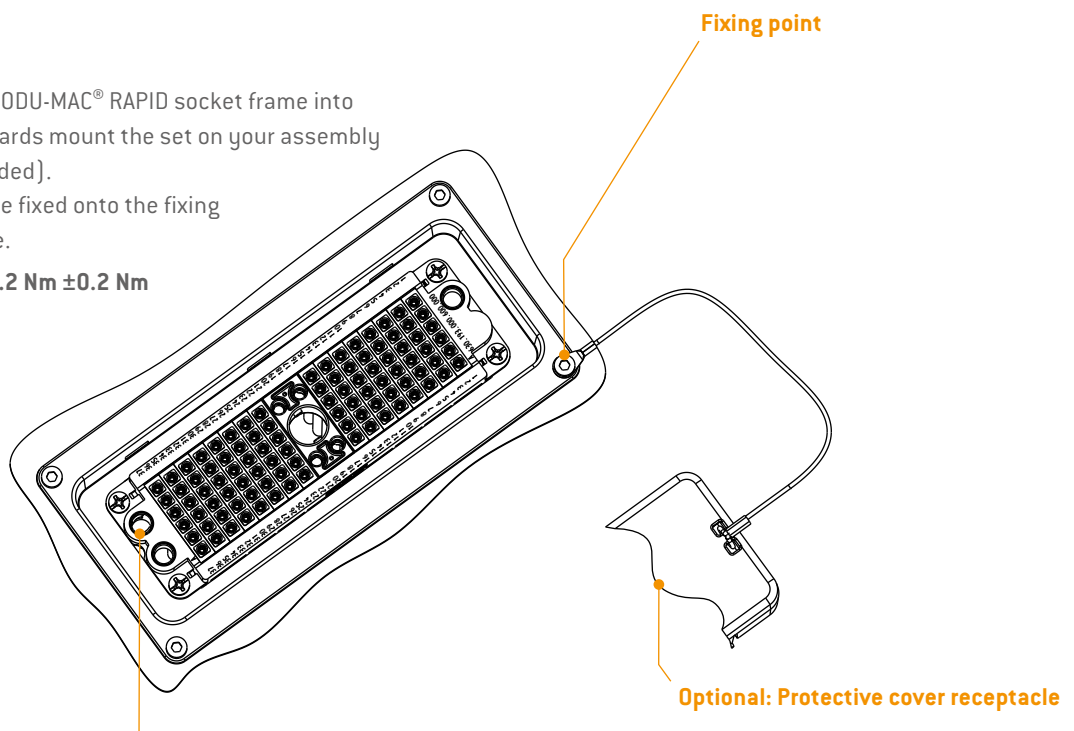

**ATTENTION!**

- ▶ Please notice the orientation of **ground pin** on the pin side!

# ODU-MAC® RAPID RECEPTACLE

B. Direct assembly of the socket frame on assembly wall

## Step 1

- Put the cable through the panel cut out.

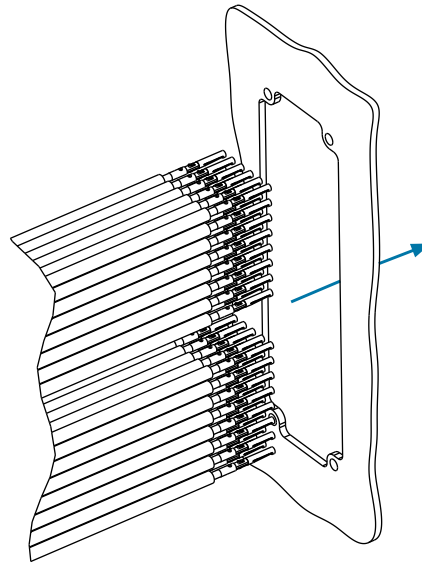

## Panel cut out

### ATTENTION!

- Mounting wall must be designed stable enough to ensure tightness!

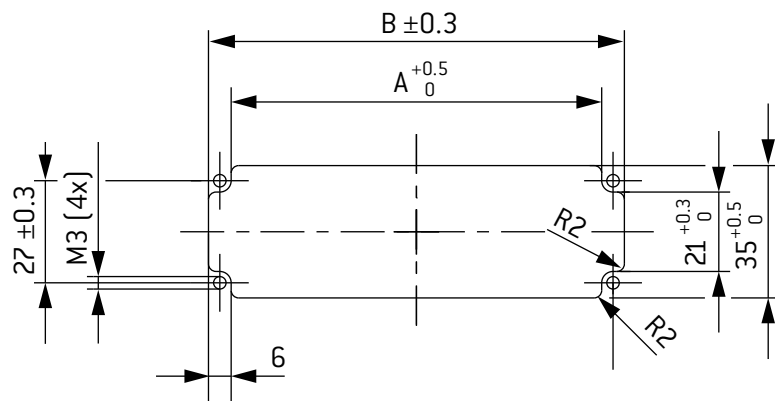

Product	Part number	Part-ID	Size	A	B
ODU-MAC® Blue-Line	631.191.000.600.001	50247184	2	51	57
ODU-MAC® White-Line	611.191.004.600.000	50267623			
ODU-MAC® Blue-Line	631.193.000.600.001	50247186	4	98	104
ODU-MAC® White-Line	611.193.004.600.000	50267625			

## Step 2

- ▶ Assemble the cables with the contacts according to the configuration and put the contacts into the modules and then into the frame.

- For ODU-MAC® Blue-Line:  
see [assembly instruction ODU-MAC® Blue-Line](#)
- For ODU-MAC® White-Line:  
see [assembly instruction ODU-MAC® White-Line](#)

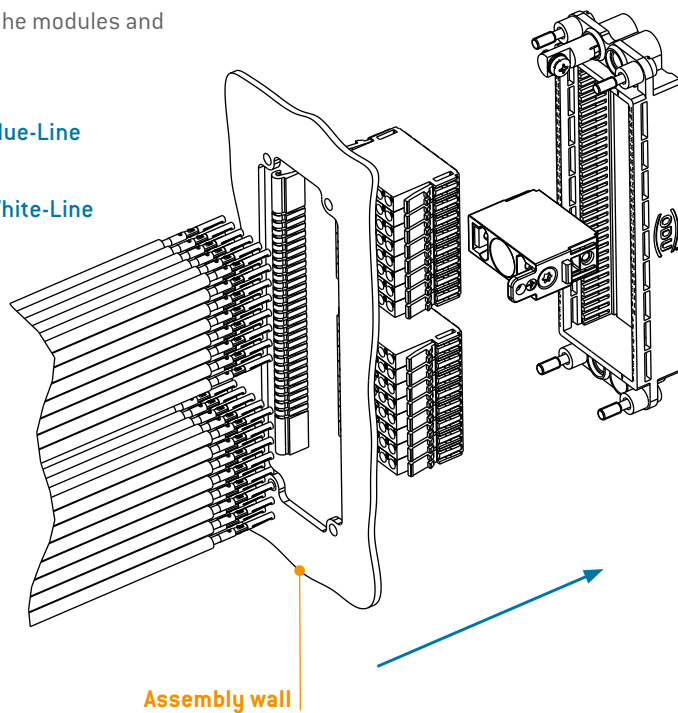

## Step 3

- ▶ Mount the assembled ODU-MAC® RAPID socket frame in the receptacle. Afterwards mount the set on the customer assembly wall (screws not included).

Max. locking torque: **1.2 Nm ±0.2 Nm**

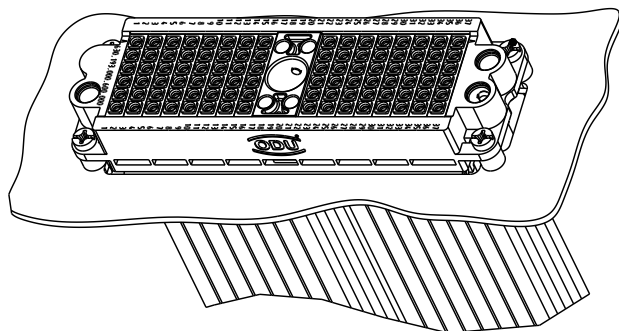

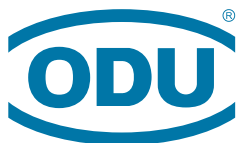

A PERFECT ALLIANCE.

## ODU GROUP WORLDWIDE

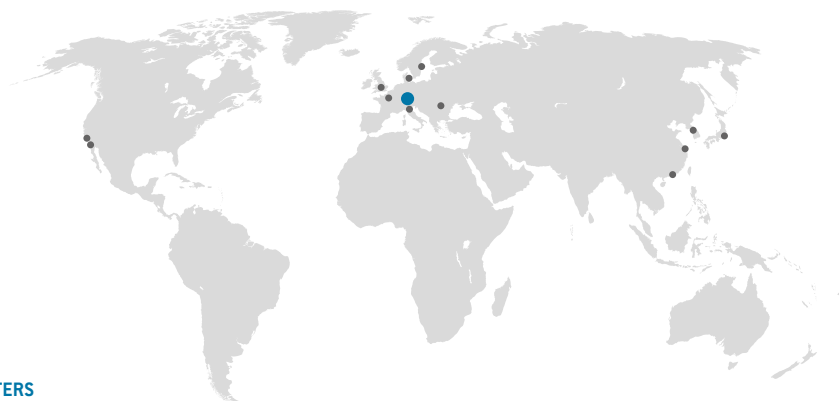

### HEADQUARTERS

#### ODU GmbH & Co. KG

Pregelstraße 11, 84453 Mühldorf a. Inn, Germany

Phone: +49 8631 6156-0, Fax: +49 8631 6156-49, E-mail: [sales@odu.de](mailto:sales@odu.de)

### SALES LOCATIONS

#### ODU (Shanghai)

International Trading Co., Ltd.

Phone: +86 21 58347828-0

E-mail: [sales@odu.com.cn](mailto:sales@odu.com.cn)

[www.odu.com.cn](http://www.odu.com.cn)

#### ODU Italia S.R.L.

Phone: +39 331 8708847

E-mail: [sales@odu-italia.it](mailto:sales@odu-italia.it)

[www.odu-italia.it](http://www.odu-italia.it)

#### ODU Scandinavia AB

Phone: +46 176 18262

E-mail: [sales@odu.se](mailto:sales@odu.se)

[www.odu.se](http://www.odu.se)

#### ODU (HK) Trading Co., Ltd.

Phone: +852 5439-9036

E-mail: [sales@odu.hk](mailto:sales@odu.hk)

[www.odu.hk](http://www.odu.hk)

#### ODU Japan K.K.

Phone: +81 3 6441 3210

E-mail: [sales@odu.co.jp](mailto:sales@odu.co.jp)

[www.odu.co.jp](http://www.odu.co.jp)

#### ODU-UK Ltd.

Phone: +44 330 002 0640

E-mail: [sales@odu-uk.co.uk](mailto:sales@odu-uk.co.uk)

[www.odu-uk.co.uk](http://www.odu-uk.co.uk)

#### ODU Denmark ApS

Phone: +45 2233 5335

E-mail: [sales@odu-denmark.dk](mailto:sales@odu-denmark.dk)

[www.odu-denmark.dk](http://www.odu-denmark.dk)

#### ODU Korea Inc.

Phone: +82 2 6964 7181

E-mail: [sales@odu-korea.kr](mailto:sales@odu-korea.kr)

[www.odu-korea.kr](http://www.odu-korea.kr)

#### ODU-USA Inc.

Phone: +1 805 484-0540

E-mail: [sales@odu-usa.com](mailto:sales@odu-usa.com)

[www.odu-usa.com](http://www.odu-usa.com)

#### ODU-France SARL

Phone: +33 1 3935-4690

E-mail: [sales@odu.fr](mailto:sales@odu.fr)

[www.odu.fr](http://www.odu.fr)

#### ODU Romania Manufacturing SRL

Phone: +40 269 704638

E-mail: [sales@odu-romania.ro](mailto:sales@odu-romania.ro)

[www.odu-romania.ro](http://www.odu-romania.ro)

#### Further information and specialized representatives can be found at:

[www.odu-connectors.com/contact](http://www.odu-connectors.com/contact)

### PRODUCTION AND LOGISTICS SITES

**Germany** Otto Dunkel GmbH

**China** ODU (Shanghai) Connectors Manufacturing Co., Ltd.

**Mexico** ODU Mexico Manufacturing S. de R.L. de C.V.

**Romania** ODU Romania Manufacturing SRL

**USA** ODU North American Logistics Inc.



Simply scan the QR code  
to download the entire publication.

All dimensions are in mm. Some figures are for illustrative purposes only. Subject to change without notice. Errors and omissions excepted. We reserve the right to change our products and their technical specifications at any time in the interest of technical improvement. This publication supersedes all prior publications. This publication is also available as a PDF file that can be downloaded from [www.odu-connectors.com](http://www.odu-connectors.com)

ODU CM INUE

ODU-MAC® RAPID assembly instruction / TI / 0121 / EN